

Smartphone Connectivity Module (SCM031B)

INTRODUCTION

Emus BMS Smartphone Connectivity Module is a low energy adapter that allows you to wirelessly monitor various battery parameters in real time on any Android device using Emus EVGUI app, or any PC running Windows operating system, using the USB dongle. The Smartphone Connectivity Module connects to the main controller using RS232 interface. A compatible EMUS EVGUI App is available on Google Play downloads section.



SUPPORTED DEVICES

- Android 4.4 or later
- All Windows OS versions with BLED112 USB dongle

FEATURES

- RS232 interface which connects EMUS Smartphone Connectivity Module to EMUS G1 Control Unit.
- Low energy BT protocol which allows monitor and configures EMUS G1 Control Unit parameters by smartphone, tablet or Windows PC using BLED112 USB dongle (dongle to be purchased separately)

MECHANICAL INFORMATION

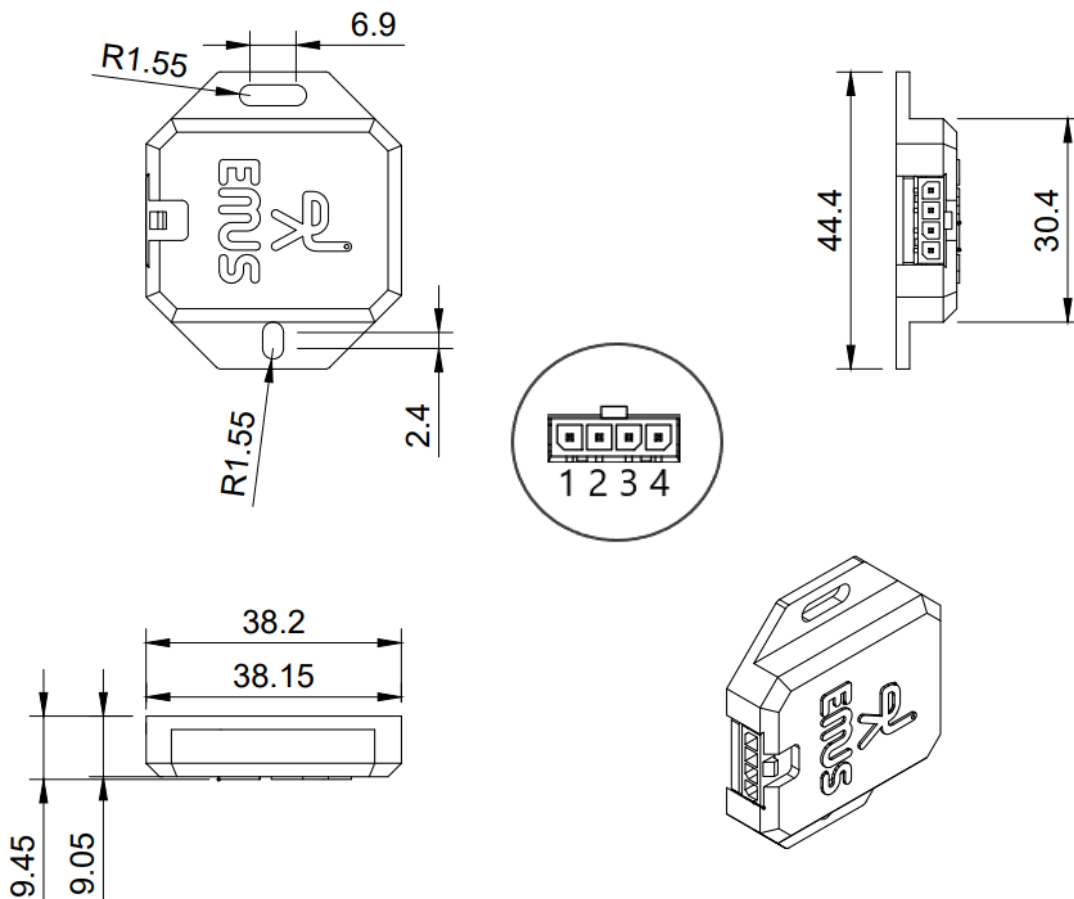



Pin No.	Wire Color	Assignment	Mating Housing	Terminal	Emus G1 BMS Control Unit pins
1	Black	GND	Molex 43645-0400	43030-0003 (recommended crimp tool Molex Hand Crimp Tool P/N: 638190000)	GND
2	White	RS232 RX			DISP. TX
3	Green	RS232 TX			DISP. RX
4	Red	PWR			PWR

ELECTRICAL CHARACTERISTICS

Item	Conditions	Value
Supply voltage		9.0 to 32.0 VDC (24.0 VDC typical)
Power supply reverse polarity protection		Yes
Current consumption	At typical supply voltage	4.4 to 9.0 mA

OTHER SPECIFICATIONS

Item	Value
Smartphone BT protocol version	2.0 + EDR
Communication range	10 m
Operating temperature	-40 to +85°C
IP rating	IP53
Weight	60 g
Cable length	1.5 m

APPLICATION

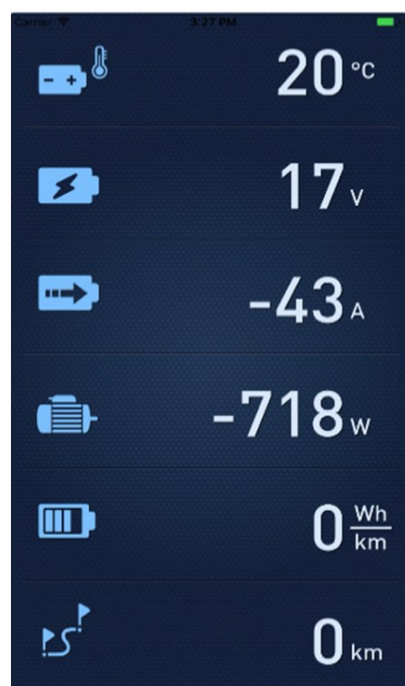

Get it on Google Play